



## Neri&Hu Design and Research Office

**project** Quijiang Museum of Fine Arts, Xi'an, China.

**standout** The crowning glory of the firm's innovative, mixed-use museum extension for retail and events programming is a lanternlike structure dubbed "the Beacon." Clad in red travertine slabs, the cylindrical edifice features evenly spaced portals that usher light down into the walkway wrapping the cylinder's base, while, up top, a hollowed-out, bowl-shape amphitheater with stepped seating encircles a lightwell that descends straight through the core.

**photography** Zhu Runzi. ➔

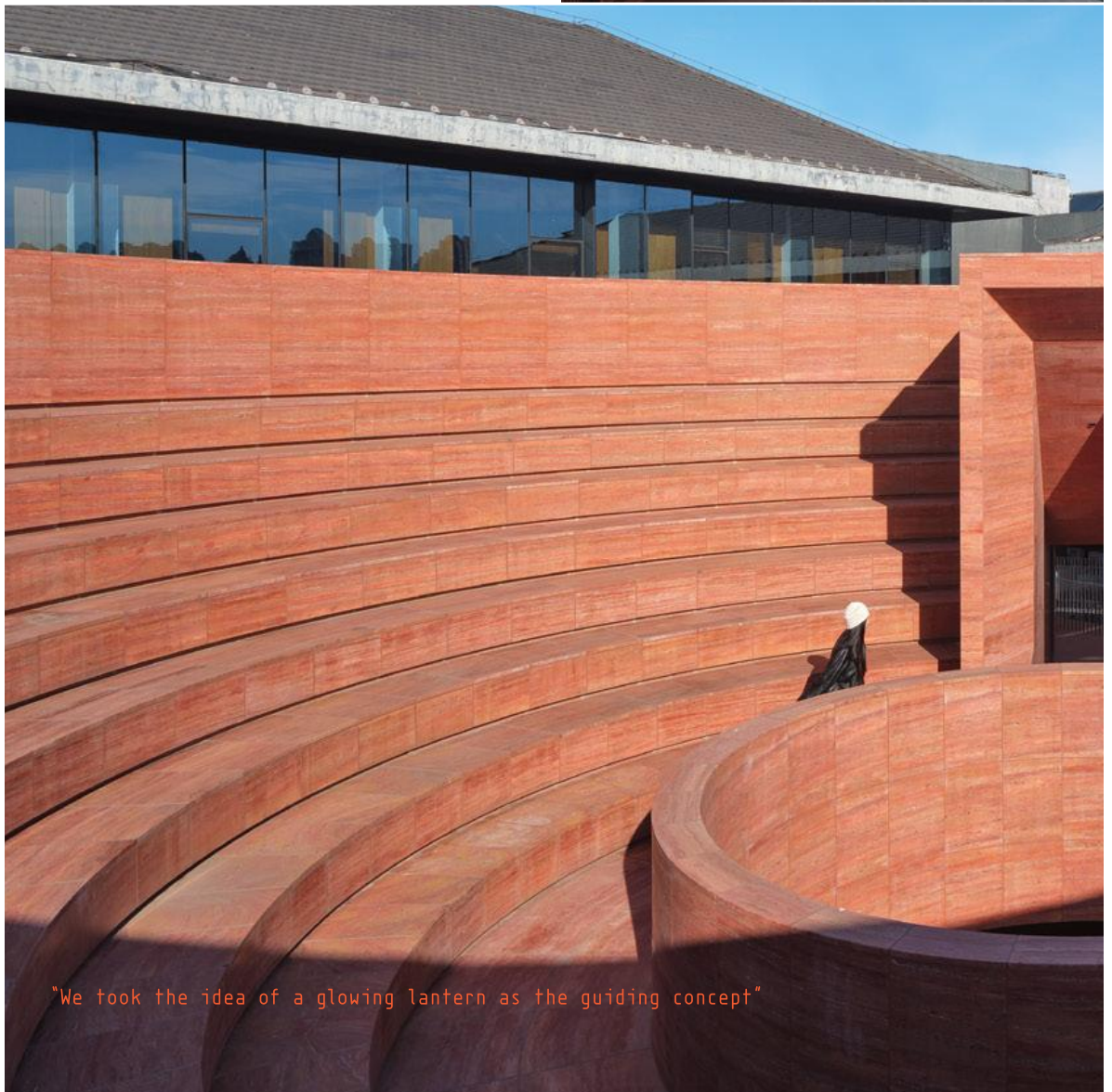

"We took the idea of a glowing lantern as the guiding concept"



